

**Jomar® BALL VALVES**

**Solderless® Ball Compression With Drain**



**MODEL C 402**  
 400 W.O.G.



**SIZES:**  
 1/2"-3/4"-1"



**ISO 9002**

**"Mini" Ball Valves**



1/4"F x 1/4"F



1/4"M x 1/4"F



1/8"M x 1/8"F

1/8"M x 1/4"F



**SIZES:**

**Eliminate Shut Down!**

**ADD-A-VALVE®**

A defective valve may be replaced or a new ball valve may be installed on hot (220°F/104°C) or cold water, including hot or chilled H<sub>2</sub>O glycol systems, under pressure, from 0 to 250 PSI/17 bar max., on M, L, K, or \*Metric copper tubing, without shutting off the water, in 30 minutes or less. (\*Specify)

**-IMPORTANT-**

On sizes 1/4"-2" on multi-story bldgs., the pumps **MUST** be shut off prior to the Add-A-Valve® package Installation

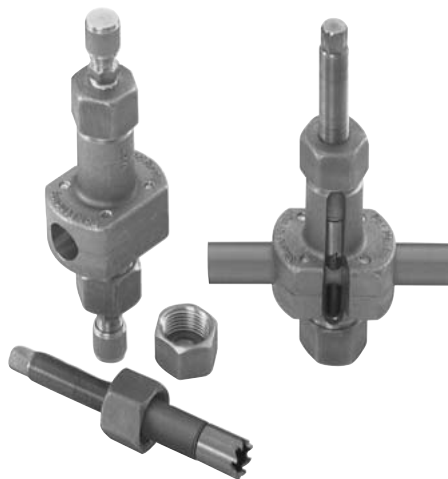

**SIZE RANGE 1/2"-2"**

The ADD-A-VALVE  
 ...is an  
**EMERGENCY**  
**SHUT OFF**  
**DEVICE, a TOOL...**  
 used to install a  
 new valve or  
 remove a  
 defective valve.

The end cap/clean out cover, serves as a line tap by the use of an adapter

**Jomar** BALL VALVES

**Medical Gas Three Piece 4-Bolt**

OXYGEN  
CLEANED AND  
BAGGED

NFPA-99C  
STANDARD

NICKEL PLATED/RUST RESISTANT,  
RUGGED STEEL HANDLE

(2) "K" COPPER TUBE  
EXTENSIONS IN INCHES

SLIP-LOCT™

DOUBLE VITON O-RINGS (STANDARD)  
TO PREVENT STEM LEAKAGE WITH  
R.T.F.E. STEM WASHER

CHROME PLATED  
BRASS BALL AND  
BRASS STEM

NICKEL PLATED  
STEM NUT

ADJUSTABLE PACKING NUT  
THREADED TO BODY

BLOW-OUT PROOF STEM  
BOTTOM LOADED  
WITH R.T.F.E. STEM SEAL

**MODEL S-675-GP-4B**

HIGH PURITY  
SERVICE

100% FULL PORT  
SIZES 1/2"-2"

THREE PIECE HOT FORGED  
BRASS BODY-ELIMINATES PINHOLES

R.T.F.E.-  
BODY SEAL/SEATS

NICKEL PLATED/  
RUST RESISTANT  
STEEL BOLTS

*Guaranteed Not To Leak . . .*

The gland follower does not need to be tightened down to eliminate leakage, due to the unique (2) O-rings/stem design, stem O-rings, chrome plated brass ball and brass stem are replaceable without removing valve from the line . . . less maintenance, better value.

**PNEUMATIC T-100P-SS-WS**

**AUTOMATIC  
DRAIN VALVE**

**JOMAR'S NEW T-100P-SS-WS** was designed with safety in mind for those industrial applications where compressed air is the prime mover. By simply shutting the valve "OFF", the downstream air pressure is automatically bled to the atmosphere, allowing maintenance procedures to be completed past the valve. This prevents accidental injury because downstream residual air pressure is no longer present.

The **NEW T-100P-SS-WS** also has a unique forged brass raised boss on the bottom of the valve. This boss is NPT threaded to accept a cone style muffler, which is furnished with the unit. This feature meets or exceeds OSHA 1910.95 for noise attenuation and air dispersal. Combine this with Jomar's "Lift N Lock®" locking system and all safety requirements can easily be met.

Jomar's Dedication to Quality is Reflected in this New Innovative Product. The Pneumatic Automatic Drain Valve carries ISO-EN 9002 approvals to insure consistency in Quality Control and Quality Assurance.

**NOTE:**

MODEL T-100P-SS-WS-L is shipped with Master Lock Model 420

MODEL T-100P-SS-WS is shipped less Master Lock

AVAILABLE IN SIZES 1/2", 3/4" AND 1"

Locking device accepts both Master Lock Model 420 or a 1/4" shank padlock.



**MODEL  
T-100P-SS-WS**

**Jomar® BALL VALVES**



**MODEL T-SS1001N**



**MODEL T-CS1001N-SS**

**T-1001N Series™**

**316 STAINLESS STEEL BALL AND STEM CARBON STEEL WITH 316 STAINLESS BALL AND STEM**

JOMAR'S T-SS1001N SERIES of steel valves are designed for rugged industrial applications of steam, water, oil, gas and corrosive materials. They feature solid ball construction, 2nd Generation P.T.F.E. seats, two piece 100% full port design, 1000 W.O.G., with latch lock handle. They are UL approved for Flammable Liquids, LP gas, natural and manufactured gas and anhydrous ammonia. CONFORMS TO SPECIFICATION MSS SP-110

**DIMENSIONS IN INCHES**

| Size   | A    | B    | C    | D    |
|--------|------|------|------|------|
| 1/4"   | 2.21 | 0.43 | 2.20 | 4.21 |
| 3/8"   | 2.21 | 0.43 | 2.20 | 4.21 |
| 1/2"   | 2.60 | 0.56 | 2.30 | 4.21 |
| 3/4"   | 2.99 | 0.81 | 2.79 | 5.73 |
| 1"     | 3.54 | 1.00 | 2.96 | 5.73 |
| 1 1/4" | 3.94 | 1.25 | 3.56 | 7.45 |
| 1 1/2" | 4.41 | 1.50 | 3.84 | 7.45 |
| 2"     | 5.00 | 1.97 | 4.24 | 8.08 |

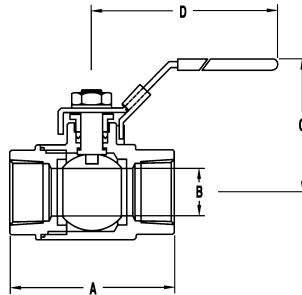

**MATERIAL SPECIFICATION**

| Part          | T-SS1001N               | T-CS1001N-SS            |
|---------------|-------------------------|-------------------------|
| Body          | CF 8M                   | WCB                     |
| Ball          | 316 SS                  | 316 SS                  |
| Stem          | 316 SS                  | 316 SS                  |
| Body Cap      | CF 8M                   | WCB                     |
| Seat          | 2nd Generation P.T.F.E. | 2nd Generation P.T.F.E. |
| Stem Packing  | R.T.F.E.                | R.T.F.E.                |
| Stem Seal     | 2nd Generation P.T.F.E. | 2nd Generation P.T.F.E. |
| Gland Ring    | 316 SS                  | CS                      |
| Handle        | 304 SS                  | CS                      |
| Spring Washer | 304 SS                  | CS                      |
| Lock Nut      | 304 SS                  | CS                      |
| Gasket        | 2nd Generation P.T.F.E. | 2nd Generation P.T.F.E. |

**Econo-Gate® CAST BRASS GATE VALVE-COMPRESSION ENDS**

JOMAR MODEL T-302 Gate valves have a screwed bonnet, non-rising stem, solid wedge disc and integral seats. Same construction as T-301/S-301 but with compression ends which eliminate soldering. Recommended for non-steam use in residential and light commercial applications. May be repacked while in service under pressure.

**PRESSURE RATING:**  
**200 PSI W.O.G. NPN-SHOCK**

**ISO 9002**  
**#5M4Y009**

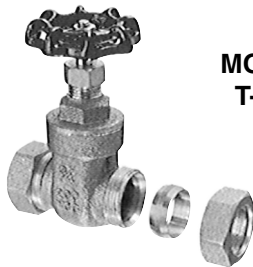

**MODEL T-302**

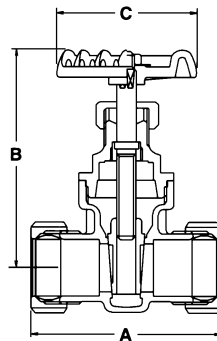

**DIMENSIONS IN INCHES**

| Valve Size | A     | B     | C     |
|------------|-------|-------|-------|
| 1/2"       | 2.522 | 2.916 | 2.128 |
| 3/4"       | 2.758 | 3.310 | 2.128 |
| 1"         | 3.152 | 3.940 | 2.403 |

**MATERIALS T-302**

| Part Name        | Material                |
|------------------|-------------------------|
| Body             | Cast Brass              |
| Bonnet           | Cast Brass              |
| Stem             | Forged Brass            |
| Packing Nut      | Cast Brass              |
| Disc             | Cast Brass              |
| Hand Wheel       | Cast Iron               |
| Wheel Nut        | Brass Rod               |
| Locknut          | Brass Rod               |
| Gland            | Brass Rod               |
| Gland Packing    | Asbestos Free Graphitic |
| Compression Ring | Brass Tube              |
| Cup Nut          | Cast Brass              |