

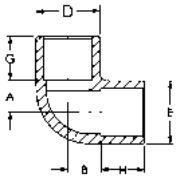

Corzan® CPVC Schedule 80 Fittings

90° Elbow  
Soc x Soc



Size	A	B	D	E	G	H
1/4	11/32	11/32	13/16	13/16	21/32	21/32
1/2	9/16	9/16	1-7/32	1-7/32	29/32	29/32
3/4	5/8	5/8	1-7/16	1-7/16	1-1/32	1-1/32
1	3/4	3/4	1-3/4	1-3/4	1-5/32	1-5/32
1-1/4	15/16	15/16	2-1/8	2-1/8	1-5/16	1-5/16
1-1/2	1-1/16	1-1/16	2-13/32	2-13/32	1-7/16	1-7/16
2	1-5/16	1-5/16	2-29/32	2-29/32	1-9/16	1-9/16
2-1/2	1-17/32	1-17/32	3-17/32	3-17/32	1-27/32	1-27/32
3	1-13/16	1-13/16	4-7/32	4-7/32	1-15/16	1-15/16
4	2-11/32	2-11/32	5-5/16	5-5/16	2-5/16	2-5/16
6	3-9/16	3-9/16	7-9/16	7-9/16	3-1/16	3-1/16
8	4-9/16	4-9/16	9-23/32	9-23/32	4-1/32	4-1/32
10	5-3/4	5-3/4	12-1/16	12-1/16	5-1/2	5-1/2
12	6-15/16	6-15/16	14-1/4	14-1/4	6-1/2	6-1/2

90° Elbow  
Soc x FPT

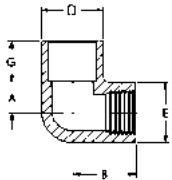

Size	A	B	D	E	G
1/2	17/32	1-5/8	1-5/16	1-5/16	1-1/16
3/4	9/16	1-3/4	1-17/32	1-17/32	1-5/32
1	3/4	1-3/8	1-27/32	1-27/32	1-11/32
1-1/4	29/32	2-11/32	2-7/32	2-7/32	1-13/32
1-1/2	1-1/16	2-11/16	2-17/32	2-17/32	1-5/8
2	1-9/32	3-1/16	3	3	1-3/4

90° Elbow  
FPT x FPT

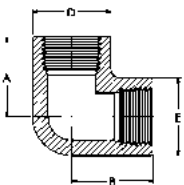

Size	A	B	D	E
1/4	15/16	15/16	7/8	7/8
1/2	1-1/4	1-1/4	1-5/16	1-5/16
3/4	1-3/8	1-3/8	1-1/2	1-1/2
1	1-23/32	1-23/32	1-13/16	1-13/16
1-1/4	1-29/32	1-29/32	2-7/32	2-7/32
1-1/2	2-3/32	2-3/32	2-17/32	2-17/32
2	2-7/16	2-7/16	3	3
2-1/2	3-23/32	3-23/32	3-9/16	3-9/16
3	4-5/32	4-5/32	4-5/16	4-5/16
4	4-13/16	4-13/16	5-3/8	5-3/8

45° Elbow  
Soc x Soc

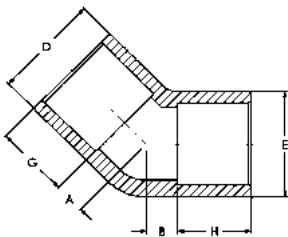

Size	A	B	D	E	G	H
1/4	5/32	5/32	7/8	7/8	21/32	21/32
1/2	9/16	9/16	1-1/16	1-1/16	1-5/16	1-5/16
3/4	5/8	5/8	1-3/32	1-3/32	1-1/2	1-1/2
1	3/4	3/4	1-11/32	1-11/32	1-13/16	1-13/16
1-1/4	15/16	15/16	2-7/32	2-7/32	1-7/16	1-7/16
1-1/2	1-1/16	1-1/16	2-17/32	2-17/32	1-5/8	1-5/8
2	1-5/16	1-5/16	3-1/32	3-1/32	1-23/32	1-23/32
2-1/2	3/4	3/4	3-1/2	3-1/2	1-13/16	1-13/16
3	13/16	13/16	4-7/32	4-7/32	1-15/16	1-15/16
4	1-1/16	1-1/16	5-5/16	5-5/16	2-5/16	2-5/16
6	3-9/16	3-9/16	7-19/32	7-19/32	3-9/16	3-9/16
8	4-9/16	4-9/16	9-3/4	9-3/4	4-1/16	4-1/16
10	2-9/16	2-9/16	12-1/16	12-1/16	5-1/2	5-1/2
12	3-1/16	3-1/16	14-1/4	14-1/4	6-1/2	6-1/2



### Corzan® CPVC Schedule 80 Fittings

45° Elbow  
FPT x FPT

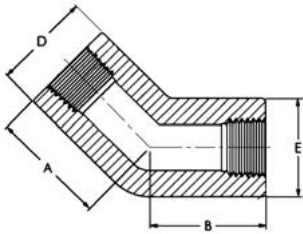

Size	A	B	D	E
1/4	3/4	3/4	7/8	7/8
1/2	1-3/8	1-3/8	1-5/16	1-5/16
3/4	1-1/2	1-1/2	1-1/2	1-1/2
1	1-23/32	1-23/32	1-13/16	1-13/16
1-1/4	1-7/8	1-7/8	2-7/32	2-7/32
1-1/2	2-3/16	2-3/16	2-17/32	2-17/32
2	2-1/2	2-1/2	3	3
2-1/2	2-21/32	2-21/32	3-9/16	3-9/16
3	2-27/32	2-27/32	4-5/16	4-5/16
4	3-7/16	3-7/16	5-5/16	5-5/16

Coupling  
Soc x Soc

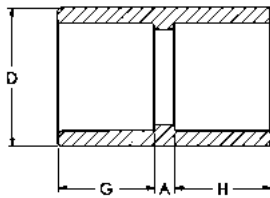

Size	A	D	G	H
1/4	1/8	13/16	9/16	9/16
1/2	5/32	1-3/16	29/32	29/32
3/4	5/32	1-13/32	1-1/32	1-1/32
1	5/32	1-3/4	1-5/32	1-5/32
1-1/4	5/32	2-1/8	1-9/32	1-9/32
1-1/2	5/32	2-3/8	1-13/32	1-13/32
2	7/32	3-1/32	1-17/32	1-17/32
2-1/2	7/32	3-9/16	2-3/16	2-3/16
3	1/8	4-7/32	1-15/16	1-15/16
4	1/8	5-5/16	2-5/16	2-5/16
6	9/32	7-9/16	3-1/16	3-1/16
8	11/32	9-23/32	4-1/16	4-1/16
10	5/16	12-1/16	5-1/2	5-1/2
12	7/16	14-1/4	6-1/2	6-1/2

Coupling-Reducing  
Soc x Reducing Soc

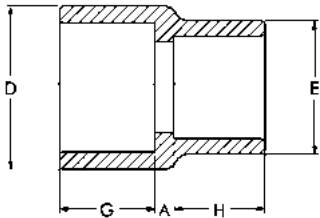

Size	A	D	E	G	H
3/4 x 1/2	3/16	1-3/8	1-3/16	1-1/32	29/32
1 x 1/2	3/16	1-11/16	1-3/16	1-5/32	29/32
1 x 3/4	1/8	1-13/16	1-1/2	1-3/16	1-1/32
1-1/4 x 1	5/16	2-1/8	1-3/4	1-5/16	1-5/32
1-1/2 x 1	9/32	2-15/32	1-13/16	1-13/32	1-5/32
1-1/2 x 1-1/4	7/32	2-15/32	2-7/32	1-13/32	1-9/32
2 x 1-1/2	1/4	3-1/32	2-1/2	1-17/32	1-3/8
3 x 2	9/16	4-5/16	3-1/32	2-3/8	1-7/8
4 x 3	7/16	5-15/32	4-11/32	2-17/32	2-7/16
6 x 4	7/16	7-1/2	5-1/4	3-1/32	2-9/32

Coupling  
FPT X FPT

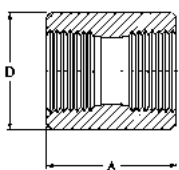

Size	A	D
1/4	1-3/8	7/8
1/2	1-15/16	1-5/16
3/4	1-31/32	1-17/32
1	1	1-27/32
1-1/4	2-11/16	2-7/32

Coupling FPT X FPT—cont'd

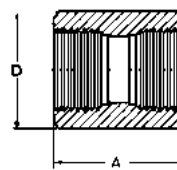

Size	A	D
1-1/2	2-15/16	2-15/32
2	3-1/4	3-1/32
2-1/2	4-9/16	3-9/16
3	4-29/32	4-11/32
4	5-1/4	5-7/16

**Colonial** ENGINEERING INC. **FITTINGS**

**Corzan® CPVC Schedule 80 Fittings**

**Tee**  
All Soc

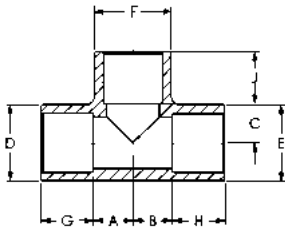

Size	A	B	C	D	E	F	G	H	J
1/2	9/16	9/16	9/16	1-9/32	1-9/32	1-9/32	1-1/16	1-1/16	1-1/16
3/4	19/32	19/32	19/32	1-17/32	1-17/32	1-17/32	1-1/8	1-1/8	1-1/8
1	3/4	3/4	3/4	1-27/32	1-27/32	1-27/32	1-5/16	1-5/16	1-5/16
1-1/4	29/32	29/32	29/32	2-7/32	2-7/32	2-7/32	1-13/32	1-13/32	1-13/32
1-1/2	1-1/16	1-1/16	1-1/16	2-1/2	2-1/2	2-1/2	1-21/32	1-21/32	1-21/32
2	1-7/32	1-7/32	1-7/32	3	3	3	1-3/4	1-3/4	1-3/4
2-1/2	1-17/32	1-17/32	1-17/32	3-9/16	3-9/16	3-9/16	2-7/32	2-7/32	2-7/32
3	1-7/8	1-7/8	1-7/8	4-7/32	4-7/32	4-7/32	1-15/16	1-15/16	1-15/16
4	2-3/8	2-3/8	2-3/8	5-7/16	5-7/16	5-7/16	2-1/2	2-1/2	2-1/2
6	3-9/16	3-9/16	3-9/16	7-19/32	7-19/32	7-19/32	3-1/16	3-1/16	3-1/16
8	4-15/32	4-15/32	4-15/32	9-23/32	9-23/32	9-23/32	4-1/32	4-1/32	4-1/32
10	5-3/4	5-3/4	5-3/4	12-1/16	12-1/16	12-1/16	5-1/2	5-1/2	5-1/2
12	6-15/16	6-15/16	6-15/16	14-1/4	14-1/4	14-1/4	6-1/2	6-1/2	6-1/2

**Tee**  
Soc x Soc x Reducing Soc

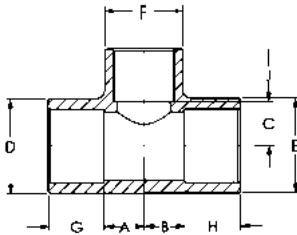

Size	A	B	C	D	E	F	G	H	J
3/4 x 3/4 x 1/2	9/16	9/16	5/8	1-1/2	1-1/2	1-7/32	1-1/16	1-1/16	29/32
1 x 1 x 1/2	19/32	19/32	13/16	1-27/32	1-27/32	1-3/16	1-1/8	1-1/8	29/32
1 x 1 x 3/4	11/16	11/16	27/32	1-27/32	1-27/32	1-13/32	1-5/32	1-5/32	1-1/32
1-1/2 x 1-1/2 x 3/4	11/16	11/16	1	2-5/16	2-5/16	1-3/8	1-3/8	1-3/8	1
1-1/2 x 1-1/2 x 1	29/32	29/32	1-5/32	2-11/32	2-11/32	1-23/32	1-3/8	1-3/8	1-1/8
2 x 2 x 1/2	17/32	17/32	1-9/32	2-29/32	2-29/32	1-7/32	1-17/32	1-17/32	29/32
2 x 2 x 3/4	19/32	19/32	1-9/32	2-29/32	2-29/32	1-7/16	1-17/32	1-17/32	1-1/32
2 x 2 x 1	23/32	23/32	1-9/32	2-29/32	2-29/32	1-13/16	1-17/32	1-17/32	1-5/32
2 x 2 x 1-1/2	1-1/32	1-1/32	1-9/32	2-29/32	2-29/32	2-1/2	1-17/32	1-17/32	1-13/32
3 x 3 x 2	1-5/16	1-5/16	1-7/8	4-7/32	4-7/32	3-1/32	1-15/16	1-15/16	1-17/32
4 x 4 x 2	1-5/16	1-5/16	2-5/16	5-5/16	5-5/16	3-1/32	2-5/16	2-5/16	1-17/32
4 x 4 x 3	1-13/16	1-13/16	2-9/32	5-5/16	5-5/16	4-7/32	2-5/16	2-5/16	1-15/16
6 x 6 x 4	2-3/8	2-3/8	3-9/32	7-9/16	7-9/16	5-1/4	3-3/32	3-3/32	2-5/16
8 x 8 x 6	3-3/4	3-3/4	4-3/16	9-11/16	9-11/16	7-17/32	4-1/32	4-1/32	3-1/32

**Tee**  
Soc x Soc x FPT

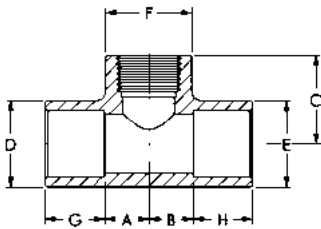

Size	A	B	C	D	E	F	G	H
1/2	9/16	9/16	2-1/4	1-9/32	1-9/32	1-9/32	1-1/16	1-1/16
3/4	5/8	5/8	2-7/16	1-17/32	1-17/32	1-17/32	1-1/8	1-1/8
1	3/4	3/4	2-31/32	1-27/32	1-27/32	1-27/32	1-5/16	1-5/16
1-1/4	15/16	15/16	3-7/16	2-7/32	2-7/32	2-7/32	1-13/32	1-13/32
1-1/2	1	1	3-15/16	2-1/2	2-1/2	2-1/2	1-21/32	1-21/32
2	1-5/16	1-5/16	4-1/2	3	3	3	1-25/32	1-25/32

**Tee**  
All FPT

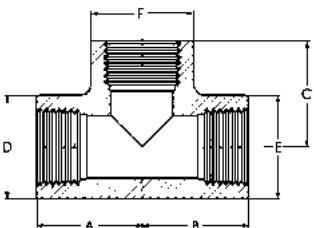

Size	A	B	C	D	E	F
1/4	31/32	31/32	31/32	7/8	7/8	7/8
1/2	1-1/4	1-1/4	1-1/4	1-9/32	1-9/32	1-9/32
3/4	7/8	7/8	7/8	1-1/2	1-1/2	1-1/2
1	5/8	5/8	5/8	1-13/16	1-13/16	1-13/16
1-1/4	1-15/16	1-15/16	1-15/16	2-7/32	2-7/32	2-7/32
1-1/2	2-1/8	2-1/8	2-1/8	2-1/2	2-1/2	2-1/2
2	2-1/2	2-1/2	2-1/2	3	3	3
2-1/2	3-23/32	3-23/32	3-23/32	3-9/16	3-9/16	3-9/16
3	4-5/32	4-5/32	4-5/32	4-5/16	4-5/16	4-5/16
4	4-13/16	4-13/16	4-13/16	5-7/16	5-7/16	5-7/16



### FITTINGS

## Corzan® CPVC Schedule 80 Fittings

**Reducing Bushing**  
Spigot x Reducing FPT

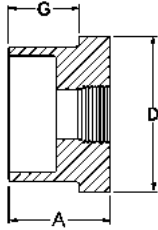

Size	A	D	G
1/2 x 1/4	31/32	15/16	25/32
3/4 x 1/2	1-1/4	1-1/8	1-1/32
1 x 1/2	1-3/8	1-3/8	1-5/32
1 x 3/4	1-3/8	1-3/8	1-5/32
1-1/4 x 1/2	1-9/16	1-23/32	1-1/4
1-1/4 x 3/4	1-1/2	1-3/4	1-9/32
1-1/4 x 1	1-9/16	1-11/16	1-9/32
1-1/2 x 1/2	1-3/4	2	1-13/32
1-1/2 x 3/4	1-5/8	1-31/32	1-7/16
1-1/2 x 1	1-5/8	1-31/32	1-7/16
1-1/2 x 1-1/4	1-3/4	2	1-13/32
2 x 1/2	1-27/32	2-13/32	1-17/32
2 x 3/4	1-3/4	2-7/16	1-9/16
2 x 1	1-3/4	2-7/16	1-9/16
2 x 1-1/4	1-3/4	2-7/16	1-9/16
2 x 1-1/2	1-3/4	2-7/16	1-9/16
2-1/2 x 2	2-1/2	3-5/16	2-7/32
3 x 2	2-5/8	4-1/32	2-3/8
3 x 2-1/2	2-5/8	4-1/32	2-3/8
4 x 2	2-13/16	4-15/16	2-1/2
4 x 3	2-25/32	4-15/16	2-1/2

**Reducing Bushing**  
MPT x Reducing FPT

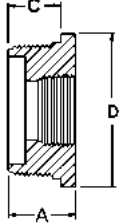

Size	A	C	D
3/4 x 1/2	1-1/32	27/32	1-1/8
1 x 1/2	1-7/32	31/32	1-11/32
1 x 3/4	1-7/32	31/32	1-11/32
1-1/4 x 1/2	1-1/4	1	1-11/16
1-1/4 x 3/4	1-1/4	1	1-11/16
1-1/4 x 1	1-1/4	1	1-11/16
1-1/2 x 1/2	1-11/32	1	1-29/32
1-1/2 x 3/4	1-11/32	1	1-15/16
1-1/2 x 1	1-11/32	1	1-29/32
1-1/2 x 1-1/4	1-11/32	1-1/32	1-29/32
2 x 1/2	1-3/8	1-1/16	2-13/32
2 x 3/4	1-13/32	1-1/16	2-13/32
2 x 1	1-13/32	1-1/16	2-13/32
2 x 1-1/4	1-13/32	1-1/16	2-13/32
2 x 1-1/2	1-13/32	1-3/32	2-13/32
2-1/2 x 2	1-9/32	2-7/32	3-5/16
3 x 1-1/2	2-5/8	2-3/8	4
3 x 2	2-5/8	2-3/8	4-1/32
3 x 2-1/2	2-5/8	2-3/8	4-1/32
4 x 2	2-25/32	2-17/32	4-15/16
4 x 3	2-25/32	2-15/32	4-15/16

**CAP\***  
Soc

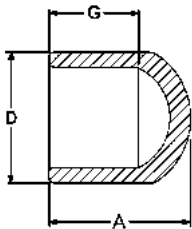

Size	A	D	G
1/4	15/16	13/16	21/32
1/2	1-3/8	1-3/16	31/32
3/4	1-19/32	1-13/32	1-1/16
1	1-25/32	1-3/4	1-5/32
1-1/4	1-31/32	2-1/8	1-11/32
1-1/2	2-7/32	2-3/8	1-1/2
2	2-11/16	3-1/32	1-11/16
2-1/2	3-11/32	3-9/16	2-9/32
3	3-7/16	4-5/16	2-3/16
4	3-23/32	5-15/32	2-17/32
6	5-19/32	7-21/32	3-21/32

NOTE: If using for water filter assembly, contact customer service for pertinent information.

**Colonial** ENGINEERING INC. **FITTINGS**

**Corzan® CPVC Schedule 80 Fittings**

**Coupling-Reducing**  
FPT x Reducing FPT

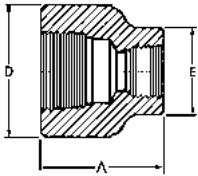

Size	A	D	E
3/4 x 1/2	2-3/8	1-19/32	1-5/16
1 x 1/2	2-23/32	1-29/32	1-5/16
1 x 3/4	2-5/16	1-13/16	1-1/2
1-1/2 X 1	2-13/16	2-15/32	1-27/32

**Female Adapter**  
Soc x FPT

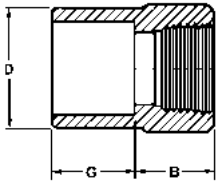

Size	B	D	G
1/4	23/32	27/32	21/32
1/2	15/16	1-5/16	29/32
3/4	15/16	1-17/32	1-1/32
1	1-1/8	1-27/32	1-5/32
1-1/4	1-1/32	2-1/8	1-5/16
1-1/2	1-1/32	2-13/32	1-7/16
2	1-5/32	2-29/32	1-9/16
2-1/2	2-3/8	3-9/16	2-3/16
3	2-9/16	4-5/16	2-11/32
4	2-23/32	5-15/32	2-17/32

**Male Adapter**  
Soc x MPT

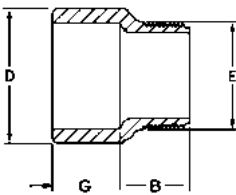

Size	B	D	E	G
1/2	1-1/8	1-7/32	7/8	29/32
3/4	1-1/8	1-7/16	1-1/16	1-1/32
1	1-9/32	1-3/4	1-3/8	1-5/32
1-1/4	1-7/32	2-1/8	1-5/8	1-5/16
1-1/2	1-9/32	2-13/32	1-7/8	1-7/16
2	1-1/4	2-29/32	2-11/32	1-17/32
2-1/2	1-17/32	3-1/2	2-27/32	1-29/32
3	1-23/32	4-3/16	3-7/16	1-15/16
4	1-3/4	5-5/16	4-7/16	2-5/16

**Reducing Bushing**  
Spigot x Reducing Soc

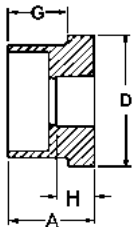

Size	A	D	G	H
1/2 x 1/4	1-3/32	1	7/8	5/8
1/2 x 3/8	1-1/16	29/32	7/8	13/16
3/4 x 1/2	1-7/32	1-1/8	1-1/32	7/8
1 x 1/2	1-7/16	1-3/8	1-3/16	7/8
1 x 3/4	1-7/16	1-3/8	1-3/16	1-1/32
1-1/4 x 1/2	1-9/16	1-23/32	1-1/4	7/8
1-1/4 x 3/4	1-9/16	1-11/16	1-9/32	1
1-1/4 x 1	1-9/16	1-11/16	1-1/4	1-5/32
1-1/2 x 1/2	1-3/4	2	1-13/32	29/32
1-1/2 x 3/4	1-3/4	2	1-13/32	1-1/32
1-1/2 x 1	1-3/4	2	1-13/32	1-5/32
1-1/2 x 1-1/4	1-3/4	2	1-7/16	1-1/4
2 x 1/2	1-3/4	2-13/32	1-17/32	29/32
2 x 3/4	1-13/16	2-13/32	1-17/32	1-1/32
2 x 1	1-13/16	2-13/32	1-17/32	1-1/8
2 x 1-1/4	1-13/16	2-13/32	1-17/32	1-1/4
2 x 1-1/2	1-13/16	2-13/32	1-17/32	1-13/32
2-1/2 x 2	2-1/8	3-5/16	2-7/32	1-17/32
3 x 1-1/2	2-1/4	3-19/32	1-31/32	1-7/16
3 x 2	2-1/4	3-19/32	1-31/32	1-9/16
3 x 2-1/2	2-1/4	3-19/32	1-31/32	1-23/32
4 x 2	2-5/8	4-9/16	2-5/16	1-9/16
4 x 3	2-5/8	4-9/16	2-5/16	1-15/16
6 x 4	3-15/32	6-3/4	3	2-5/16
8 x 6	4-19/32	8-3/4	4-1/8	3-1/16



## Corzan® CPVC Schedule 80 Fittings

**Flange Blind Soc**

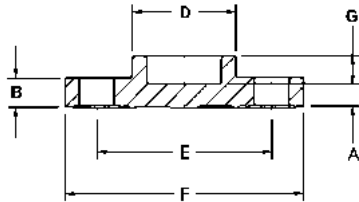

Size	A	B	D	E	F	G
1/2	1-1/32	15/32	1-5/16	2-3/8	3-1/2	15/32
3/4	9/32	1/2	1-17/32	2-3/4	3-7/8	1/2
1	15/32	9/16	1-27/32	3-1/8	4-1/4	7/16
1-1/4	1/2	21/32	2-1/4	3-1/2	4-5/8	13/32
1-1/2	7/16	23/32	2-1/2	3-7/8	5	15/32
2	1/2	25/32	3	4-3/4	6	7/16
2-1/2	1/2	13/16	3-19/32	5-1/2	7	19/32
3	25/32	15/16	4-5/16	6	7-1/2	13/32
4	21/32	1-1/16	5-1/2	7-1/2	9-1/16	1/2
6	13/16	1-1/32	7-11/16	9-1/2	11-1/32	3/4

**Flange Van Stone Style Loose Ring Soc**

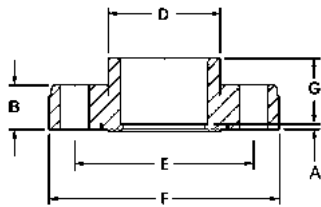

Size	A	B	D	E	F	G
1-1/2	1/8	31/32	2-1/2	3-7/8	5	1-7/16
2	1/8	1-1/16	3	4-3/4	6	1-9/16
2-1/2	3/16	1-3/16	3-9/16	5-1/2	7	1-13/16
3	5/16	1-11/32	4-3/16	6	7-5/8	2-1/8
4	7/16	1-3/8	5-1/4	7-1/2	9-1/8	2-1/4
6	13/32	1-5/8	7-19/32	9-1/2	11-1/32	3-3/16
8	3/8	2-1/16	9-23/32	11-3/4	13-9/16	4-1/8

**Union Soc x Soc with O-ring made of Viton®**

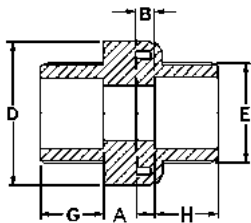

Size	A	B	D	E	G	H
1/2	29/64	1/8	2	1-17/64	3/4	3/4
3/4	47/64	33/64	2-9/32	1-1/2	13/16	13/16
1	19/32	11/32	2-21/32	1-27/32	1-5/32	1-5/32
1-1/4	43/64	11/32	3-3/32	2-5/32	1-9/32	1-9/32
1-1/2	45/64	29/64	3-3/8	2-41/64	1-13/32	1-13/32
2	3/4	15/64	4-1/16	3	1-17/32	1-17/32
3	19/64	21/64	6-1/4	4-7/16	1-29/32	1-29/32

**Union FPT x FPT with O-ring made of Viton®**

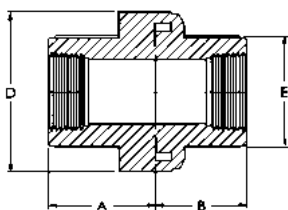

Size	A	B	D	E
1/2	1-13/64	7/8	2	1-17/64
3/4	1-35/64	1-21/64	2-9/32	1-1/2
1	1-3/4	1-1/2	2-21/32	1-27/32
1-1/4	1-61/64	1-5/8	3-3/32	2-5/32
1-1/2	2-7/64	1-55/64	3-3/8	2-41/64
2	2-9/32	1-49/64	4-1/16	3
3	2-13/64	2-15/64	6-1/4	4-7/16



**Corzan® CPVC Schedule 80 Fittings**

**Cap \*  
FPT**

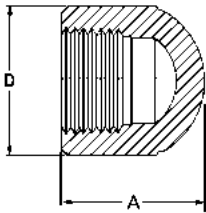

Size	A	D
1/4	7/8	13/16
1/2	1-1/4	1-5/16
3/4	1-11/16	1-17/32
1	1-17/32	1-27/32
1-1/4	2-1/8	2-7/32
1-1/2	2-9/32	2-15/32
2	1-15/16	3-1/32
2-1/2	3-11/32	3-9/16
3	3-7/16	4-5/16
4	3-11/16	5-7/16

NOTE: If using for water filter assembly, contact customer service for pertinent information.

**Plug  
MPT**

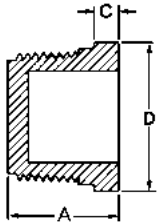

Size	A	C	D
1/4	13/16	19/32	11/16
1/2	1	25/32	29/32
3/4	1-1/32	27/32	1-1/8
1	1-7/32	31/32	1-11/32
1-1/4	1-1/4	1	1-11/16
1-1/2	1-11/32	1-1/32	1-29/32
2	1-7/16	1-1/16	2-13/32
2-1/2	2-1/32	1-5/8	2-31/32
3	2-11/16	2-3/8	4
4	2-13/16	2-9/16	4-15/16

**Flange Companion  
Soc**

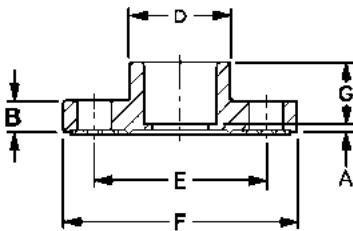

Size	A	B	D	E	F	G
1/2	3/16	7/16	1-5/16	2-3/8	3-1/2	29/32
3/4	5/32	17/32	1-17/32	2-3/4	3-7/8	1-5/16
1	5/32	19/32	1-27/32	3-1/8	4-1/4	1-5/32
1-1/4	5/32	5/8	2-7/32	3-1/2	4-5/8	1-9/32
1-1/2	5/32	23/32	2-1/2	3-7/8	5	1-3/8
2	7/32	25/32	3	4-3/4	6	1-17/32
2-1/2	7/32	7/8	3-9/16	5-1/2	7	1-25/32
3	7/32	31/32	4-5/16	6	7-1/2	1-7/8
4	5/16	1-1/16	5-17/32	7-1/2	9-1/16	2-9/32
6	7/32	1-1/16	7-23/32	9-1/2	11-1/32	3

**Flange Companion  
FPT**

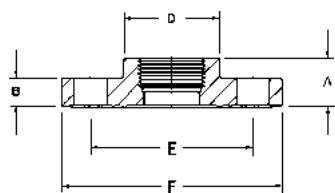

Size	A	B	D	E	F
1/2	1-1/16	7/16	1-5/16	2-3/8	3-1/2
3/4	1-15/32	17/32	1-17/32	2-3/4	3-7/8
1	1-5/16	19/32	1-27/32	3-1/8	4-1/4
1-1/4	1-13/32	5/8	2-7/32	3-1/2	4-5/8
1-1/2	1-17/32	23/32	2-1/2	3-7/8	5
2	1-23/32	25/32	3	4-3/4	6
2-1/2	1-31/32	7/8	3-9/16	5-1/2	7
3	2-3/32	31/32	4-5/16	6	7-1/2
4	1-9/32	1-1/16	5-17/32	7-1/2	9-1/16



### Corzan® CPVC Schedule 80 Fittings

#### 90° Elbow

Flange x Flange

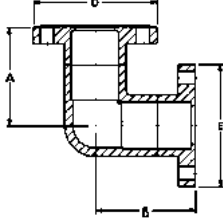

Size	A	B	D	E
1	3-7/32	3-7/32	4-1/4	4-1/4
1-1/4	3-21/32	3-21/32	4-5/8	4-5/8
1-1/2	4-1/32	4-1/32	5	5
2	4-19/32	4-19/32	6	6
2-1/2	5-11/32	5-11/32	7	7
3	5-27/32	5-27/32	7-1/2	7-1/2
4	7-1/4	7-1/4	9-1/16	9-1/16
6	9-27/32	9-27/32	11-1/32	11-1/32

#### 45° Elbow

Flange x Flange

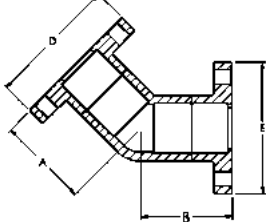

Size	A	B	D	E
1	3-7/8	3-7/8	4-1/4	4-1/4
1-1/4	3-25/32	3-25/32	4-5/8	4-5/8
1-1/2	4-7/32	4-7/32	5	5
2	4-3/4	4-3/4	6	6
2-1/2	4-17/32	4-17/32	7	7
3	4-27/32	4-27/32	7-1/2	7-1/2
4	5-31/32	5-31/32	9-1/16	9-1/16
6	10-11/32	10-11/32	11-1/32	11-1/32

#### Tee

Flange x Flange x Flange

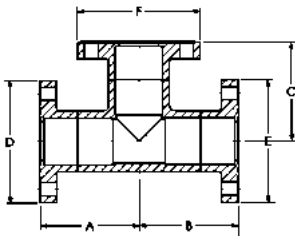

Size	A	B	C	D	E	F
1	3-3/8	3-3/8	3-3/8	4-1/4	4-1/4	4-1/4
1-1/4	3-23/32	3-23/32	3-23/32	4-5/8	4-5/8	4-5/8
1-1/2	4-1/4	4-1/4	4-1/4	5	5	5
2	4-11/16	4-11/16	4-11/16	6	6	6
2-1/2	5-23/32	5-23/32	5-23/32	7	7	7
3	5-29/32	5-29/32	5-29/32	7-1/2	7-1/2	7-1/2
4	7-15/32	7-15/32	7-15/32	9-1/16	9-1/16	9-1/16
6	9-27/32	9-27/32	9-27/32	11-1/32	11-1/32	11-1/32

#### PRESSURE RATING

CYCLIC LOADING AND WATER HAMMER SUBSTANTIALLY REDUCE MAXIMUM WATER PRESSURE RATINGS. REFER TO FACTORY FOR FURTHER INFORMATION.

Maximum non-cyclic, non-shock water pressure ratings for CPVC Schedule 80 fittings at 73°F are reflected in the following chart.

Pipe Size	Socket Fitting	Threaded Fitting	Flange Fitting
1/4	1130 psi	570 psi	
3/8	920 psi	460 psi	
1/2	850 psi	425 psi	150 psi
3/4	690 psi	340 psi	150 psi
1	630 psi	322 psi	150 psi
1-1/4	520 psi	262 psi	150 psi
1-1/2	475 psi	240 psi	150 psi
2	400 psi	200 psi	150 psi
2-1/2	425 psi	210 psi	150 psi
3	370 psi	190 psi	150 psi
4	325 psi	160 psi	150 psi
6	285 psi		150 psi

**Temperature Correction Factors.** Maximum operating pressures are directly affected by escalation of temperature. The following chart provides the corollary for necessary adjustments. (See Note A)

Temperature	Derating
80°F	96% of rated pressure at 73°F
100°F	85% of rated pressure at 73°F
120°F	70% of rated pressure at 73°F
140°F	50% of rated pressure at 73°F
160°F	40% of rated pressure at 73°F
180°F	25% of rated pressure at 73°F
200°F	20% of rated pressure at 73°F
210°F	15% of rated pressure at 73°F

NOTE A: Temperature correction factors apply to socket fittings, threaded fittings and flange fittings.

CAUTION: Do not use compressed air or gas for pressure testing.